



Prestons Park Subdivision
GEOTECHNICAL REPORT FOR LOT 781
CDL Land NZ Limited

5 August 2024
Revision: 0
Reference: 235361

*Bringing ideas
to life*

Document control record

Document prepared by:

Aurecon New Zealand Limited

Level 2, Iwikau Building
93 Cambridge Terrace
Christchurch 8013
New Zealand

T +64 3 366 0821

F +64 3 379 6955

E christchurch@aurecongroup.com

W aurecongroup.com

A person using Aurecon documents or data accepts the risk of:

- a) Using the documents or data in electronic form without requesting and checking them for accuracy against the original hard copy version.
- b) Using the documents or data for any purpose not agreed to in writing by Aurecon.

Document control						aurecon	
Report title		GEOTECHNICAL REPORT FOR LOT 781					
Document ID			Project number		235361		
File path		https://aurecongroup.sharepoint.com/sites/235361/5 Deliver Design/064 to 069 Stage 2/069 Stage 2 Building Consent/Stage Z2/Lot 781/235361 Building Consent Report Lot 781.docx					
Client		CDL Land NZ Limited					
Client contact		Melissa Crowe	Client reference				
Rev	Date	Revision details/status	Author	Reviewer	Verifier (if required)	Approver	
0	5 August 2024	For Issue	A Payne	R Lawler		J Kupec	
Current revision		0					

Approval			
Author signature		Approver signature	
Name	Abby Payne	Name	Dr Jan Kupec
Title	Geotechnical Engineer	Title	Principal, Ground Engineering

Contents

1	Executive Summary	1
2	Introduction	2
3	Site Conditions	3
3.1	Site Description	3
3.2	Surface Water	3
3.3	Regional Geology	3
3.4	Site Earthworks	3
3.5	Technical Classification	3
4	Geotechnical Assessment	5
4.1	General	5
4.2	Previous Investigations	5
4.3	Hand Held Testing	5
4.4	Dynamic Cone Penetrometers	5
4.5	Groundwater Levels	5
4.6	Topsoil Depth	5
5	Foundation Recommendations	7
5.1	Foundation Types	7
5.2	Foundation Construction Recommendations	7
6	References	8
7	Explanatory Statement	9

Appendices

Appendix A

Figures

Appendix B

Test Results

1 Executive Summary

CDL Land NZ Ltd has commissioned Aurecon New Zealand Ltd to undertake site specific geotechnical investigations and assessments for individual residential lots for building consent purposes for the Prestons Park Subdivision Stage 2. This report documents the results of the geotechnical assessment and presents geotechnical comments together with foundation recommendations for the residential building on Lot 781 at the Prestons Park Subdivision.

As part of the subdivision development extensive geotechnical testing, including cone penetration tests (CPTs), were carried out to define the liquefaction potential at the overall subdivision. **Based on our information the property is likely to perform to a level equivalent to Technical Category 1 (TC1 - Grey) set by the Ministry of Business, Innovation and Employment (MBIE) in their guidelines issued in December 2012.**

The site development has included extensive bulk earthworks. All earthworks and compliance testing have been undertaken in accordance with the earthworks specification. The engineering sign off and bulk earthworks are documented in the Geotechnical Completion Report. The earthfill at the subdivision construction stage was placed and signed off in accordance with NZS4431:1989. Based on review of the available geotechnical information, including bulk earthworks information and NZS4431 compliance records, we consider that a determination in accordance with NZS3604:2011 Section 3.1.3 is appropriate, and the property meets the requirements for NZS3604 type foundations.

The geotechnical site specific assessment comprised a review of previous geotechnical investigations undertaken for the subdivision development and a site specific geotechnical investigation. A single hand auger borehole was undertaken to assess the upper soil profile and groundwater level. Two dynamic cone penetrometers (DCPs) were carried out on the lot, one of the DCPs was located immediately adjacent to the hand auger borehole with the second DCP located on the opposite half of the lot.

Based on our knowledge of the site setting and our past work we recommend that any residential structure that is to be developed on Lot 781 be founded on standard NZS3604:2011 compliant foundations.

These foundations require a minimum geotechnical ultimate bearing capacity of at least 300kPa, which for Lot 781 is achieved at a minimum depth of 0.3m below ground level as this represents the current thickness of the topsoil and loose material.

This report shall be read as a whole. Our limitations are presented in Section 7.

2 Introduction

CDL Land NZ Ltd is currently undertaking a large residential subdivision with associated commercial lots. Previously Aurecon New Zealand Ltd has undertaken detailed geotechnical investigations and assessments for the purpose of the plan change, subdivision resource consent application, liquefaction assessment, technical classification of the entire subdivision, and observation of bulk earthworks construction.

Aurecon New Zealand Ltd has since been commissioned to undertake site specific geotechnical investigations and assessment of individual lots for building consent application purposes. The site which this report is focused on comprises a single lot, designated Lot 781 at the Prestons Park Subdivision to the south of Prestons Road in Marshland, Christchurch. This report documents the results of the geotechnical assessment and presents geotechnical comments together with foundation recommendations for the proposed residential building on the lot. We note that at the time of writing this report the location and structural form of the dwelling were unknown, and it is inferred to comprise NZS3604:2011 type residential buildings only.

This report shall be read as a whole. Our limitations are presented in Section 7.

3 Site Conditions

3.1 Site Description

The Prestons Subdivision is located on the northern fringes of Christchurch City. The site is made up of a series of adjacent properties forming an irregular and elongated rectangle shape, orientated approximately north to south. The total area of the overall Prestons Subdivision site is approximately 190ha. The site can be separated into two distinct blocks, Prestons North which runs from the Lower Styx Road in the north through to Prestons Road in the south and the Prestons Park development which continues from Prestons Road through to Mairehau Road to the south.

This building consent report is for Lot 781 which is located in Stage 2 of the Prestons Park Subdivision development (refer Figure 1 in Appendix A). The lot is bordered by residential lots to the north, west and east and Mairehau Road to the south.

3.2 Surface Water

There are no natural sources of surface water on the subdivision. There is a stormwater channel to the north and a stormwater basin to the northeast of Lot 781.

3.3 Regional Geology

The geology of the site is described in the 1:250,000 scale geological map – ‘*Geology of the Christchurch Area*’, published in 2008 by the Institute of Geological and Nuclear Sciences. Note this map has been referenced as it is at an appropriate scale and covers the entire site. The map indicates the underlying geology comprises ‘*Dominantly sand of fixed and semi-fixed dunes and beach deposits*’ and ‘*drained peat swamp*’. The subdivision geotechnical investigation identified that this area was predominantly underlain by aeolian (dune) and beach sand deposits.

The GNS Active Fault System database (GNS, 2012a) indicates that the site is located approximately:

- 27km northeast of the eastern end of the Greendale Fault System. Movement on the Greendale Fault System was responsible for the Magnitude 7.1 Darfield (Canterbury) Earthquake on 4 September 2010.
- 14km north of the epicentre of the Magnitude 6.2 Christchurch Earthquake on 22 February 2011.
- 12km northwest of the Magnitude 6.0 earthquake on 13 June 2011 (GNS, 2012b).
- 8km northwest of the Magnitude 5.9 earthquake on 23 December 2012.

3.4 Site Earthworks

Site earthworks have been undertaken to prepare the site for residential building purposes. Historical subdivision scale earthworks involved the cutting of an existing sand dune, further cutting to remove unsuitable shallow material and subsequent engineered filling. The site finished surface levels exist in a combination of cut and fill.

All earthworks and compliance testing have been undertaken in accordance with the earthwork’s specification. Details of the site bulk earthworks are provided in the Aurecon report titled ‘*Prestons Park Subdivision – Stage R3, S3, Z2, T4, and T5 Geotechnical Completion Report Rev 0*’ dated 29 February 2024. The Geotechnical Completion Report has been completed as part of the requirements of NZS4404:2010 ‘*Land development and subdivision infrastructure*’ and Christchurch City Council ‘*Infrastructure Design Standards - Part 4: Geotechnical Requirements*’. The compacted fill was placed and signed off in accordance with NZS4431:1989 ‘*Code of practice for earth fill for residential development*’.

3.5 Technical Classification

The landcheck maps historically provided on The Canterbury Earthquake Recovery Authority (CERA) website indicated the site is classified as rural and unmapped. The technical categories were

developed by the Ministry for Business, Innovation and Employment (MBIE) with the support from the Engineering Advisory Group (EAG) in mid-2011 and hence prior to the start of the subdivision development. The site has since been modified by civil engineering and bulk earthworks.

As part of the subdivision consent geotechnical assessment, site specific liquefaction assessment was carried out over the wider subdivision area. This is detailed in Aurecon's reports titled '*Prestons Road Subdivision, Geotechnical Assessment Report for Resource Consent*', Revision 2 dated 5 March 2012, '*Prestons Road Subdivision, Detailed Geotechnical Design Report*', Revision 2 dated 12 July 2012 and '*Prestons South Subdivision Resource Consent Geotechnical Report*', Revision 1 dated 6 June 2013.

Based on the results from our liquefaction assessment and bulk earthworks undertaken on the wider subdivision, Lot 781 is likely to perform to a level equivalent to Technical Category 1 (TC1 - Grey) in the MBIE Guidelines issued in December 2012.

4 Geotechnical Assessment

4.1 General

The geotechnical assessment comprised a review of relevant previous geotechnical investigations and construction data, and an in-situ geotechnical investigation. The geotechnical investigation comprised handheld testing on the individual lot. A single hand auger borehole was undertaken to assess the upper soil profile and the groundwater level. Two dynamic cone penetrometers (DCPs) were carried out on the lot. The handheld testing was undertaken on the lot following the site earthworks. The testing density is considered reasonable as the geotechnical engineers were involved in the observation of the civil engineering works.

4.2 Previous Investigations

The previous geotechnical testing and investigations undertaken by Aurecon across the entire subdivision site comprised a combination of cone penetrometer tests (CPT) and machine excavated test pits. Further details regarding these investigation locations are found in the Aurecon report titled '*Prestons Park Subdivision – Stage R3, S3, Z2, T4, and T5 Geotechnical Completion Report Rev 0*' dated 29 February 2024.

4.3 Handheld Testing

One hand auger borehole was undertaken on the lot as part of the geotechnical investigation to assess the upper soil profile and the groundwater level. The test location and the borehole log have been uploaded to the New Zealand Geotechnical Database (NZGD). The borehole log is attached in Appendix B.

The hand auger borehole was terminated when soil samples became too dense to auger. The hand auger borehole indicates ground conditions comprise topsoil underlain by gravel.

The logging of the recovered hand auger samples was undertaken in accordance with the New Zealand Geotechnical Society's "*Guideline for the Field Classification and Description of Soil and Rock for Engineering Purposes: 2005*".

4.4 Dynamic Cone Penetrometers

Two DCPs were carried out with the locations and results uploaded to the NZGD. The DCP test results are attached in Appendix B. One of the DCPs was located adjacent to the hand auger borehole, with the second DCP located on the opposite half of the lot.

DCP logs indicate 5 blows per 100mm penetration, which is equivalent to an ultimate bearing capacity of 300kPa, was consistently encountered from a depth of 0.3m.

4.5 Groundwater Levels

Groundwater was not encountered due to shallow auger refusal. Nearby investigations indicate that groundwater is typically encountered at approximately 1m to 2m depth. We note that the groundwater level could vary depending on the time of year.

A review of the NZGD indicates that regional groundwater levels are likely to be in the order of 1m to 2m below ground level. These groundwater levels are reasonably consistent with those measured during the investigation, when taking into account the subdivision earthworks filling and cutting.

4.6 Topsoil Depth

The depth of topsoil has been determined from the single hand auger and two DCPs undertaken on site. We note that the topsoil depths may vary by +/- 100mm between the testing locations and hence it is recommended that at least a 100mm tolerance should be allowed for building foundation excavations.

If greater certainty of topsoil depths across the whole site is required for construction costing, then further testing would be necessary across the footprint of the proposed structure (unknown at the time of writing this report). **The responsibility and liability for any additional testing shall be met by the section purchaser.**

5 Foundation Recommendations

The site is expected to perform in line with TC1 requirements in future earthquakes. Due to the residential land use of the development, the presence of certified fill and the TC1 technical classification, future residential development will be able to adopt standard NZS3604 compliant foundations.

5.1 Foundation Types

It is recommended that residential structures that are built on Lot 781 are founded on standard NZS3604:2011 compliant foundations. These foundations require a minimum geotechnical ultimate bearing capacity of at least 300kPa. The site investigation results indicate that approximately 250mm of topsoil was present, which will need to be removed and the clean subgrade exposed for foundation construction.

Based on our understanding of the site works and the investigation results, we recommend that NZS3604:2011 compliant foundations are embedded a minimum depth of 0.3m below current ground level.

5.2 Foundation Construction Recommendations

Construction should proceed in accordance with the NZS3604:2011. Topsoil should be removed from beneath the floor slab and compacted hardfill placed under the floor slab to the required level. In addition, the following recommendations should be considered:

1. To ensure that excavated footings are adequately founded we recommend that excavations should be undertaken by a digger fitted with a smooth edge bucket. The base should be tidily trimmed by hand, lightly compacted with a plate compactor and immediately covered with a concrete tidy slab or 100mm of compacted granular hardfill. A suitable qualified engineer with foundation experience or territorial authority building inspector should be retained to verify the adequate founding has been achieved and all loose and soft or compressible material was removed.
2. If there are significant soft layers beneath a sub-excavation, the softer material will have to be excavated and backfilled with 10MPa concrete or compacted hardfill underneath all load bearing foundation elements. For the hardfill, the sub-excavation will have to have plan dimensions of $B+2D$ where B is the footing width and D is the depth of undercut. For 10MPa concrete the sub-excavation can have the same dimensions as the footing.
3. Depending on the soil encountered, the time of year, and fluctuations of the groundwater level, it is possible that excavations may encounter groundwater. The building contractor is to take appropriate measures to deal with any groundwater ingress to the foundation excavations and keep the excavations and backfill free of groundwater intrusions until the footings are cast.
4. The footing excavations are likely to expose layers of granular soils, which can be adversely affected by rainfall or stormwater. Foundation excavations should not be left open for more than three days. In addition, rainfall and stormwater should not be allowed to pond within the footing excavations as this may affect the bearing capacity of the subsoils.

6 References

Forsyth, Barrell & Jongers, (compilers), 2008. *Geology of the Christchurch Area*. Institute of Geological and Nuclear Sciences, 1:250,000 Geological Map 16.

New Zealand Geotechnical Database (2020). <https://www.nzgd.org.nz>

Christchurch City Council, 2010. *Infrastructure Design Standards - Part 4: Geotechnical Requirements*.

Geonet, 2012. <ftp://ftp.geonet.org.nz/strong/processed/Proc> (23/10/12)

GNS, 2012a. <http://maps.gns.cri.nz/website/af/viewer.htm> (23/10/12)

GNS, 2012b. <http://www.gns.cri.nz/Home/News-and-Events/Media-Releases/earthquake-part-of-aftershock-sequence> (23/10/12)

Ministry of Business Innovation and Employment (MBIE), 2012 '*Repairing and rebuilding houses affected by the Canterbury earthquakes*'.

NZGS, 2005. *Guidelines for the Classification and Field Description of Soils and Rocks in Engineering*. NZ Geotechnical Society Inc, Wellington, New Zealand.

NZS 3604:2011. *Timber Framed Buildings*. Standards New Zealand, Wellington, New Zealand.

NZS 4404:2010 *Land development and subdivision infrastructure*. Standards New Zealand, Wellington, New Zealand.

NZS 4431:1989 *Code of practice for earth fill for residential development*. Standards New Zealand, Wellington, New Zealand.

7 Explanatory Statement

We have prepared this report in accordance with the brief as provided. The contents of the report are for the sole use of the Client for the purpose of building consent application only, and no responsibility or liability will be accepted to any other third party. Data or opinions contained within the report may not be used in other contexts or for any other purposes without our prior review and agreement.

The recommendations in this report are based on data collected at specific locations and by using suitable investigation techniques with limited site coverage. Only a finite amount of information has been collected to meet the specific financial and technical requirements of the Client's brief and this report does not purport to completely describe all the site characteristics and properties. The nature and continuity of the ground and groundwater between test locations has been inferred using experience and judgment and it must be appreciated that actual conditions could vary from the assumed model.

Subsurface conditions relevant to construction works should be assessed by contractors who can make their own interpretation of the factual data provided. They should perform any additional tests as necessary for their own purposes.

Subsurface conditions, such as groundwater levels, can change over time. This should be borne in mind, particularly if the report is used after a protracted delay.

This report is not to be reproduced either wholly or in part without our prior written permission.



Appendix A

Figures

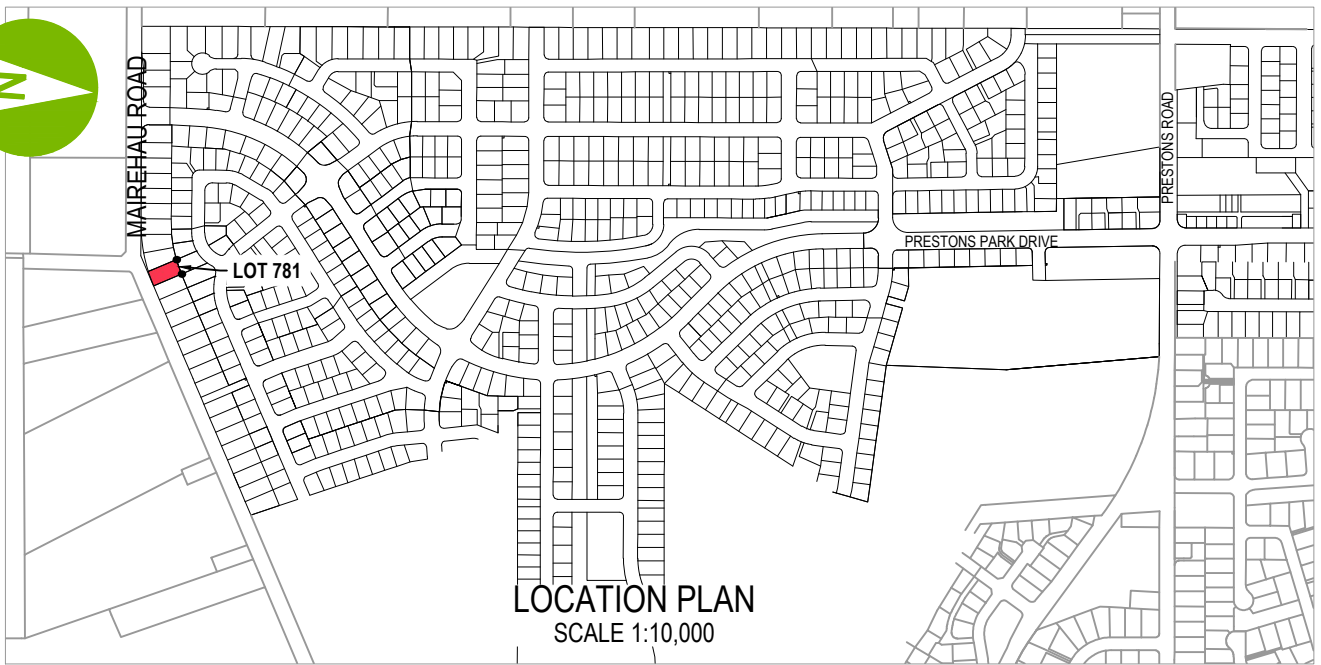

aurecon
www.aurecongroup.com

CLIENT
PRESTONS PARK

REV	DATE	REVISION DETAILS
A	29/07/2024	ISSUE FOR INFORMATION

APPROVED
J KUPEC

DRAWN
J TODD

DESIGNED
C DOHERTY

CHECKED
A PAYNE

APPROVED
J KUPEC

DATE
29/07/24

J KUPEC

PROJECT
PRESTONS PARK

TITLE
**LOT 781
SITE LOCATION PLAN
FIGURE 1**

PRELIMINARY
NOT FOR CONSTRUCTION

PROJECT No.
235361

SCALE
1:400

DRAWING No.
GO-PS-S2-IN-781

SIZE
A4

REV
A



Appendix B

Test Results

DRILLING INFORMATION Method: Hand Auger Equipment: Scala Penetrometer Contractor: N/A	CO-ORDINATES: NZTM Easting: 1573416m Northing: 5185199m Ground Level: 14.5m (LVD 1937)	Date started: 24/07/2024 Date completed: 24/07/2024 Inclination: 90° Orientation: N/A	Logged by: AP Input by: AP Reviewed by: RL Verified by: MvL
---	---	--	--

Depth (m)	Graphic Log	Soil Description	Testing	● Scala Penetrometer Test (Blows/100mm)	Additional Observations	R.L. (m)
		0m: Sandy SILT with trace rootlets and gravel; brown. Moist; sand, fine to coarse; gravel, fine to coarse, subrounded to subangular. (TOPSOIL)		3 6 9 12 15 18 21 24 27		
		Hand Auger terminated at 0.25m (Effective refusal)				
1						14
2						13
						12

REMARKS:
[1] Coordinates are approximate (+/- 5m), recorded in the field with a mobile device.
[2] RL is approximate (+/-0.5m) based on design contours.

Water Level Readings:
Date Time | Hole Depth | Water Level
No water level recorded



Level 2, Iwakau Building
93 Cambridge Terrace, PO Box 1061
Christchurch, New Zealand
Tel: +64 3 366 0821
www.aurecongroup.com

Client: **CDL Land NZ Ltd**
Project: **Prestons Park Subdivision**
Location: **Prestons Park, Christchurch**
Project Reference: **235361**

Lot 781 DCP2

Sheet 1 of 1

DRILLING INFORMATION
Method: Scala Penetrometer
Equipment: Scala Penetrometer
Contractor: N/A

CO-ORDINATES: NZTM
Easting: 1573424m
Northing: 5185236m
Ground level: 14.4m
(LVD 1937)

Date started: 24/07/2024
Date completed: 24/07/2024
Inclination: 90°
Orientation: N/A

Logged by: AP
Input by: AP
Checked by: RL
Verified by: MVL

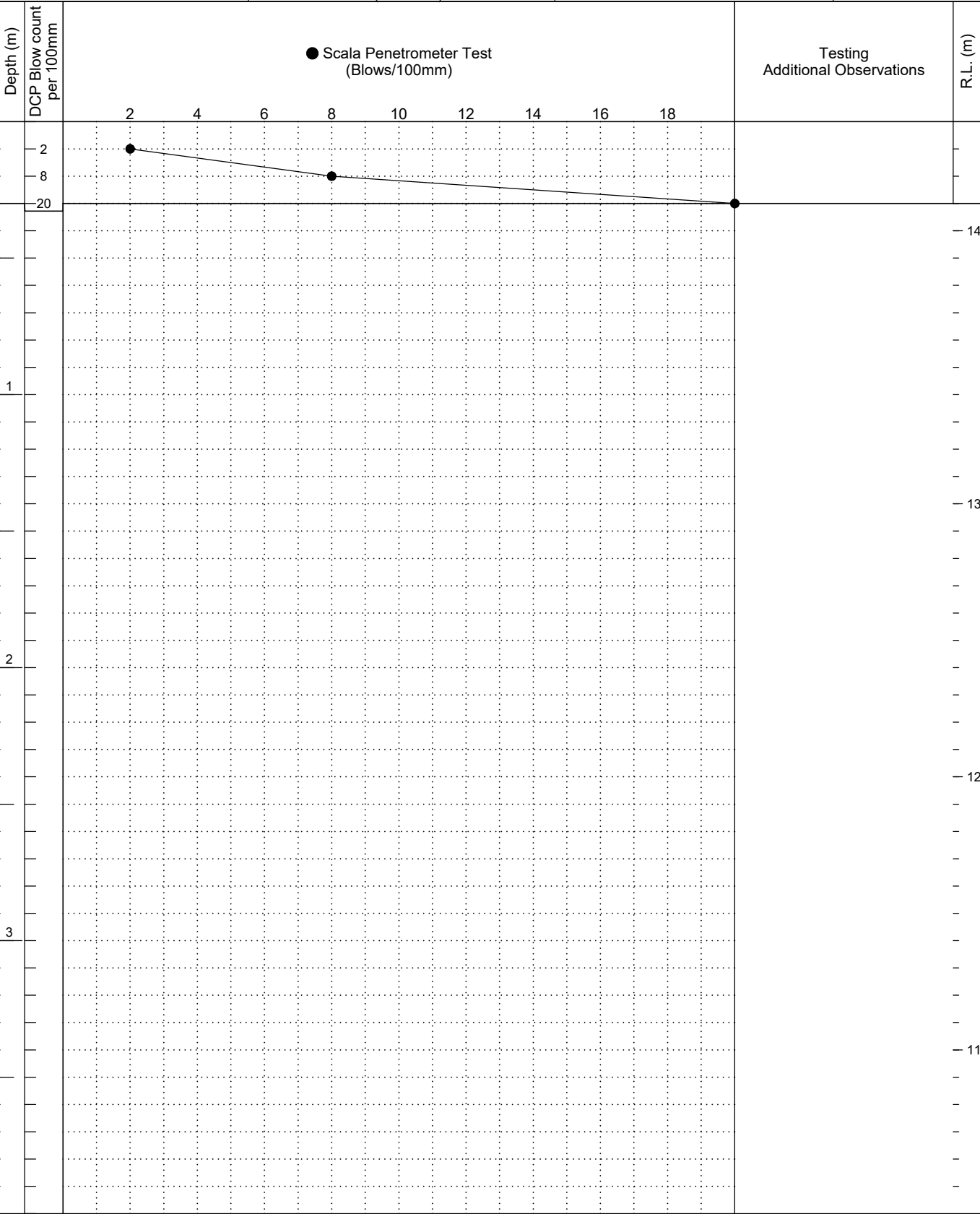

REMARKS:
[1] Coordinates are approximate (+/- 5m), recorded in the field with a mobile device.
[2] RL is approximate (+/-0.5m) based on design contours.

Water Level Readings:
Date Time | Hole Depth | Water Level
Groundwater level not encountered



*Bringing ideas
to life*

Aurecon New Zealand Limited

Level 2, Iwikau Building
93 Cambridge Terrace
Christchurch 8013
New Zealand

T +64 3 366 0821

F +64 3 379 6955

E christchurch@aurecongroup.com

W aurecongroup.com

Aurecon offices are located in:

Angola, Australia, Botswana, China,
Ghana, Hong Kong, Indonesia, Kenya,
Lesotho, Macau, Mozambique,
Namibia, New Zealand, Nigeria,
Philippines, Qatar, Singapore, South Africa,
Swaziland, Tanzania, Thailand, Uganda,
United Arab Emirates, Vietnam.