

SUBJECT TO FINAL COUNCIL APPROVAL

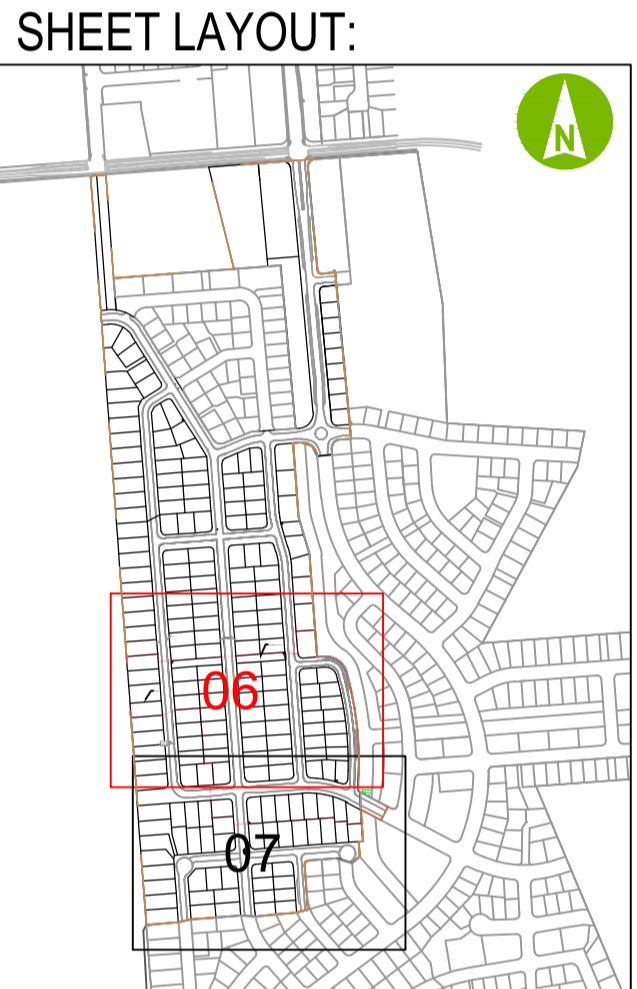

- LEGEND:**
- STORMWATER MAIN
 - STORMWATER LATERAL
 - STORMWATER MANHOLE (STANDARD)
 - STORMWATER MANHOLE (C.C.C SD303)
 - DOUBLE SUMP
 - SINGLE SUMP
 - CORNER SUMP TO BUBBLE UP
 - DOUBLE CORNER SUMP
 - STORMWATER SUMP LEAD
 - STAGE BOUNDARY
 - SUB-STAGE BOUNDARY

- NOTES:**
1. ALL SUMP LEADS ARE 2250 UNLESS OTHERWISE STATED.
 2. REFER TO DRAWINGS AB-PN-S1-SL-04-05 FOR STORMWATER LONGSECTIONS.
 3. ALL STORMWATER HOUSE CONNECTIONS ARE 1000 PVC-U SN16.
- SURVEY ORIGIN DATA:
 VERTICAL ELEVATIONS ARE IN TERMS OF CHRISTCHURCH DRAINAGE DATUM. SCIRT PUBLISHED JUNE 2011.
 THE ORIGIN OF LEVELS IS BM 3257 (EHDK), RL 15.160m (POINT #578 ON PLAIN FACE) LOCATED AT THE INTERSECTION OF APLINE VIEW LANE, WAITIKIRI DRIVE & LEN HALE PLACE.
 HORIZONTAL COORDINATES ARE IN TERMS OF NZ GEODETIC DATUM 2000.
 MOUNT PLEASANT 2000 CIRCUIT.

This AS BUILT drawing has been prepared based on information provided by the contractor.

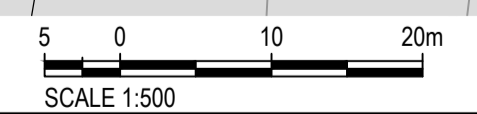

REV	DATE	REVISION DETAILS	APPROVED
1	18/07/16	AS BUILT	K.ASHBY

DRAWN	DESIGNED
J.WARLICH-KOOLE	C.CHOW
CHECKED	
J.WHITE	
APPROVED	
K.ASHBY	DATE 10/08/16
K.ASHBY	

PROJECT	
PRESTONS PARK	
TITLE	
PRESTONS SOUTH - STAGE 1 - SUBSTAGE O STORMWATER AS BUILT LAYOUT PLAN SHEET 1 OF 2	

AS BUILT	
PROJECT No.	
235361	
SCALE	SIZE
1:500	A1
DRAWING No.	REV
AB-PS-S1-SP-06	1