



PRESTONS ROAD

VAC MAIN 4-1

STAGE 2

ROAD P1

ROAD T6

ASSET ID #	mN	mE	ASSET DESCRIPTION	39	812486.319	395219.272	SLUICE VALVE - STAGE M BOUNDARY
1	812760.729	395069.877	MAIN JUNCTION (VAC MAIN 5-0 & VAC MAIN 5-1)	40	812585.748	395234.365	SLUICE VALVE
2	812759.983	395069.917	REDUCER	41	812588.18	395239.882	LATERAL (VC-01) - MAIN JUNCTION
3	812754.652	395095.187	MAIN JUNCTION (VAC MAIN 5-0 & VAC MAIN 5-1A)	42	812582.431	395243.117	VACUUM PIT VC-01
4	812766.282	395100.452	SLUICE VALVE	43	812594.698	395256.888	LATERAL (VC-01A) - MAIN JUNCTION
5	812754.028	395096.456	LATERAL (VA-01) - MAIN JUNCTION	44	812601.052	395254.87	VACUUM PIT VC-01A
6	812747.935	395093.621	VACUUM PIT VA-01	45	812598.825	395277.719	MAIN JUNCTION (VAC MAIN 5-0 & VAC MAIN 5-3A)
7	812740.625	395111.247	LATERAL (VA-01A) - MAIN JUNCTION	46	812572.528	395284.473	LATERAL (VC-02) - MAIN JUNCTION
8	812743.996	395116.462	VACUUM PIT VA-01A	47	812572.784	395290.439	VACUUM PIT VC-02
9	812712.289	395128.823	LATERAL (VA-02) - MAIN JUNCTION	48	812538.424	395287.146	LATERAL (VC-03) - MAIN JUNCTION
10	812708.87	395123.368	VACUUM PIT VA-02	49	812538.379	395293.027	VACUUM PIT VC-03
11	812709.214	395130.729	LATERAL (VA-02A) - MAIN JUNCTION	50	812518.664	395288.624	LATERAL (VC-04) - MAIN JUNCTION
12	812712.29	395136.511	VACUUM PIT VA-02A	51	812518.336	395283.834	VACUUM PIT VC-04
13	812665.877	395157.781	MAIN JUNCTION (VAC MAIN 5-0 & VAC MAIN 5-2)	52	812504.232	395289.733	LATERAL (VC-05) - MAIN JUNCTION
14	812662.823	395153.823	SLUICE VALVE	53	812504.215	395295.579	VACUUM PIT VC-05
15	812642.559	395125.055	LATERAL (VB-01) - MAIN JUNCTION	54	812758.533	395064.705	SLUICE VALVE - STAGE M BOUNDARY
16	812645.859	395118.698	VACUUM PIT VB-01	55	812623.328	395191.706	VACUUM PIT VA-03A
17	812606.416	395123.768	LATERAL (VB-02) - MAIN JUNCTION	56	812612.22	395281.884	SLUICE VALVE
18	812606.782	395129.055	VACUUM PIT VB-02	57	812963.622	395328.086	SLUICE VALVE (VM4-0)
19	812568.86	395126.938	LATERAL (VB-03) - MAIN JUNCTION	58	812962.685	395328.665	SLUICE VALVE (VM3-0)
20	812568.397	395121.208	VACUUM PIT VB-03	59	812937.766	395330.267	MAIN JUNCTION (VAC MAIN 4-0 & VAC MAIN 4-1)
21	812532.772	395129.569	LATERAL (VB-04) - MAIN JUNCTION	60	812851.140	395335.198	MAIN JUNCTION (VAC MAIN 4-0 & VAC MAIN 4-2)
22	812533.025	395134.791	VACUUM PIT VB-04	61	812806.677	395339.950	MAIN JUNCTION (VAC MAIN 3-0 & VAC MAIN 3-1)
23	812489.547	395133.028	LATERAL (VB-05) - MAIN JUNCTION	62	812778.631	395342.475	LATERAL (VD-01) - MAIN JUNCTION
24	812488.973	395127.435	VACUUM PIT VB-05	63	812697.103	395349.500	LATERAL (VD-02) - MAIN JUNCTION
25	812664.498	395158.609	SLUICE VALVE	64	812636.682	395353.610	LATERAL (VD-03) - MAIN JUNCTION
26	812627.336	395181.753	LATERAL (VA-03) - MAIN JUNCTION	65	812636.500	395353.619	REDUCER
27	812623.82	395176.397	VACUUM PIT VA-03	66	812607.381	395390.738	LATERAL (MAINTENANCE VALVE) - VAC MAIN 3-0
28	812620.995	395185.735	LATERAL (VA-03A) - MAIN JUNCTION	67	812607.923	395398.518	SLUICE VALVE
29	812598.402	395199.78	LATERAL (MAINTENANCE VALVE) - VAC MAIN 5-0	68	812570.607	395359.130	LATERAL (MAINTENANCE VALVE) - VAC MAIN 4-0
30	812595.772	395194.084	MAINTENANCE VALVE	69	812566.090	395359.768	SLUICE VALVE
31	812581.504	395209.648	MAIN JUNCTION (VAC MAIN 5-0 & VAC MAIN 5-3)	70	812935.433	395317.806	SLUICE VALVE
32	812578.272	395210.958	LATERAL (VA-04) - MAIN JUNCTION	71	812807.663	395352.552	SLUICE VALVE
33	812575.117	395206.316	VACUUM PIT VA-04	72	812777.314	395350.444	VACUUM PIT VD-01
34	812566.072	395213.316	REDUCER	73	812696.400	395358.013	VACUUM PIT VD-02
35	812520.303	395216.743	LATERAL (VA-05) - MAIN JUNCTION	74	812635.207	395363.552	VACUUM PIT VD-03
36	812520.306	395210.376	VACUUM PIT VA-05	75	812601.707	395392.173	MAINTENANCE VALVE
37	812512.691	395217.249	LATERAL (VA-06) - MAIN JUNCTION	76	812568.392	395353.746	MAINTENANCE VALVE
38	812513.787	395223.644	VACUUM PIT VA-06				

SHEET LAYOUT:

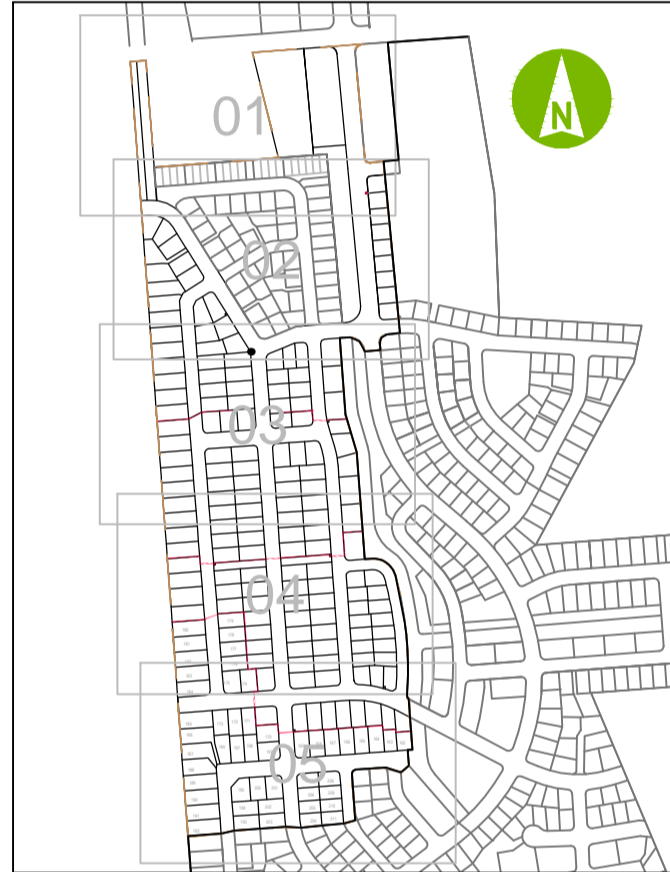

LEGEND:

- STAGE BOUNDARY
- STAGE M BOUNDARIES
- VACUUM MAINS PE100 PN12.5 SDR13.6
- 900D
- 1250D
- 1600D
- 2000D
- 2500D
- 2800D
- FLOVAC VACUUM INTERFACE VALVE
- ECCENTRIC REDUCER
- DIVISION VALVE
- MAINTENANCE RISER
- VACUUM SEWER VENT INTAKE PILLAR
- CONCRETE CAPPING
- LIFT

This AS BUILT drawing has been prepared based on information provided by the contractor.

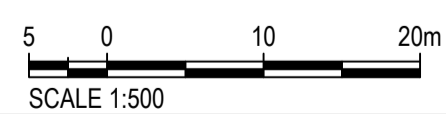

REV	DATE	REVISION DETAILS	APPROVED
1	08/08/15	AS BUILT	K.ASHBY

DRAWN	DESIGNED
M.PEPERE	I.DUNCAN
CHECKED	
K.RITSON	
APPROVED	
	DATE 08/08/15
K.ASHBY	

PROJECT
PRESTONS SOUTH
TITLE
PRESTONS SOUTH - STAGE 1 VACUUM SEWER AS BUILT LAYOUT PLAN SHEET 1 OF 3

AS BUILT
PROJECT No. 235361
SCALE 1:500
DRAWING No. AB-PS-S1-VS-01
SIZE A1
REV 1